

Go Traffic Management

This drawing has been produced for a specific client & project identified below and is not intended for use by any other person or for any other purpose. © Go Traffic Management

RISKS

- Design completed from information provided + google maps desktop risk assessment
- Cone lamps must be used on all road with a speed limit of 40mph or more.

NOTES

- All signs as per Chapter 8. Distances between cones to be 9m maximum unless otherwise noted.
- Distances between signs NOT to scale for purpose of clarity.
- All sign placement subject to available safe working space.
- The purpose of the Traffic Management Plan is for it to be used only as a guide and all traffic management equipment should be put out according to the "Safety at Street Works and Road Works - Code of Practice", i.e. Red Book & the "Traffic Signs Manual Chapter 8", i.e. Yellow Book.
- Signs must be placed in accordance with TSM and the scheme RAMS pack.
- Site conditions may have changed since the design of the drawing any changes which subsequently affect the design need to be reported by the Traffic Management Operative & any changes implemented must comply with Chapter 8.

| Key | |
|-----|------------------------------------|
| | Sign position and aspect of vision |
| | Cones |
| | Working Space |
| | Safety Zone |
| | Barriers |
| | Diverison Route 1 |

MINIMUM 0.5M SIDEWAYS & 0.5M LONGWAYS SAFETY ZONE MUST BE ADHERED TO

WORK AREA LESS THAN 0.5 MILES

Traffic Management must comply with The Safety at Street Works and Road Works Code of Practice

ROAD SPEED



CROSS SECTION

ROAD CLOSURE

| REV. | DATE | DESCRIPTION |
|------|----------|-------------|
| A | 29/05/26 | AS DRAWN |



Head Office: Go Traffic Management, Chaddock Lane, Worsley, Manchester, M28 1XW
Tel: 0161 351 5370
www.gtm.co.uk

TRAFFIC MANAGEMENT PLAN

Client: Dŵr Cymru Welsh Water

Drawing Number: 1801032.0001

Drawing Title: Unnamed Rd, Llandysul SA44 6NX

| Design: | Technical Officer: | REV: |
|-------------------|--------------------|------|
| Name: M. Gardiner | SC | |
| Signature: | | A |
| Date: 28/05/26 | 28/05/26 | |

Note:
As per request.

CLOSED - Unnamed road
DIVERSION VIA -
Head north-east
0.4 mi
Turn right
0.8 mi
Turn right
Destination will be on the left
0.7 mi
& VICE VERSA

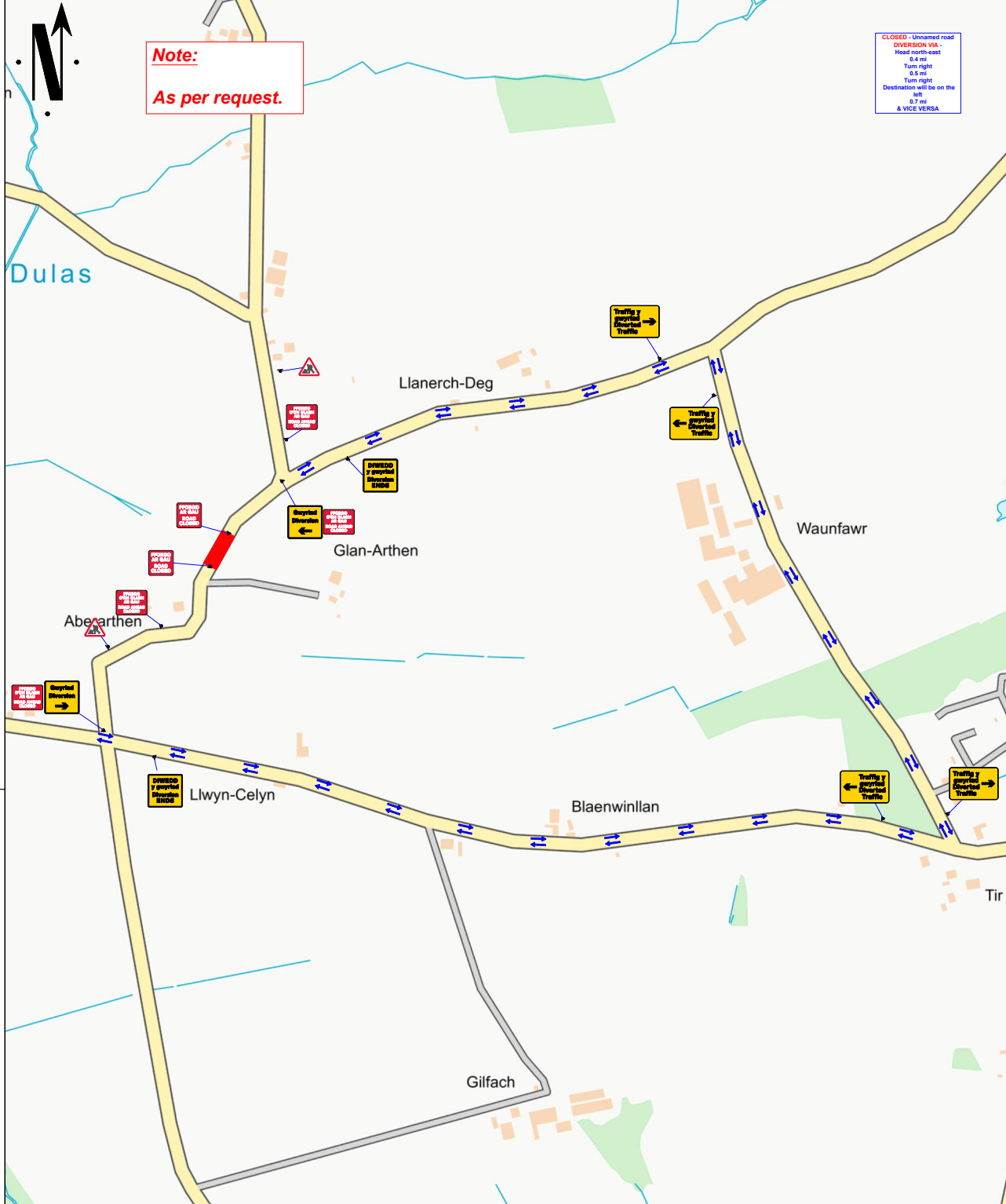

| | |
|--|--|
| Qty: 1 Ref: 2702 Diversion | |
| Qty: 2 Ref: 2702 Diversion Ends | |
| Qty: 1 Ref: 2702 Diversion | |
| Qty: 2 Ref: 2703 Diverted traffic | |
| Qty: 2 Ref: 2703 Diverted traffic | |
| Qty: 2 Ref: 7001 Road works ahead | |
| Qty: 2 Ref: 7010.1 Nature of temporary hazard ahead - Road Closed | |
| Qty: 4 Ref: 7010.1 Nature of temporary hazard ahead - Road Ahead Closed | |

