



(Cyhoeddwyd | Issued : 31/01/2025)

**DEDDF DRWYDDEDU 2003 | LICENSING ACT 2003**  
**TRWYDDED ANHEDDAU | PREMISES LICENCE**

Cyngor Sir **Ceredigion** County Council

Rhif trwydded | Premises licence number:

**PRM 0034 (Cyhoeddwyd | Issued : 31/01/2025)**

**Rhan 1 – Manylion am y safle | Part 1 - Premises details**

**Cyfeiriad post y safle, neu os nad oes un, cyfeirnod map ordnans neu ddisgrifiad:  
Postal address of premises, or if none, ordnance survey map reference or description:**

**THEATR MWLDAN / MWLDAN THEATRE  
BATH HOUSE ROAD**

**Tref bost | Post town  
ABERTEIFI / CARDIGAN**

**Côd Post | Post cod  
SA43 1JY**

**Rhif ffôn | Telephone number  
01239 623923**

**Os oes cyfyngiad ar yr amser, y dyddiadau | Where the licence is time limited the dates  
NID OES CYFYNGIADAU AMSER AR Y DRWYDDED  
PREMISES LICENCE IS NOT TIME LIMITED**

**Gweithgareddau trwyddedadwy a ganiateir gan y drwydded:  
Licensable activities authorised by the licence:**

**ADLONIANIANT WEDI EI REOLEIDDIO / REGULATED ENTERTAINMENT:**

**DRAMAU - Dan Do /PLAYS - Indoors**

**FFILMIAU – Dan Do / FILMS - Indoors**

**CHWARAEON DAN DO / INDOOR SPORTING EVENTS**

**ADLONIANIANT PAFFIO NEU RESLO – Dan Do / BOXING OR WRESTLING - Indoors**

**CERDDORIAETH BYW – Dan Do / LIVE MUSIC – Indoors and Outdoors**

**CERDDORIAETH WEDI RECORDIO – Dan Do - RECORDED MUSIC – Indoors and Outdoors**

**UNRHYW BETH SY’N DEBYG I’R HYN SY’N CAEL EI GYNNWYS O FEWN CERDDRIAETH FYW,**

**CERDDORIAETH WEDI EI RECORDIO NEU PERFFORMIADAU DAWNS – Dan Do / ANYTHING of SIMILAIR DESCRIPTION TO LIVE or RECORDED MUSIC or PERFORMANCES of DANCE – Indoors and Outdoors**

**PEFFORMIADAU DAWNS – Dan Do - PERFORMANCES OF DANCE – Indoors and Outdoors**

**CYFLEUSTERAU AR GYFER ADLONIANIANT / FACILITIES for ENTERTAINMENT:**

**CREU CERDDORIAETH – Dan Do a Ty Fas / MAKING MUSIC – Indoors and Outdoors**

**DAWNSIO – Dan Do a Ty Fas / DANCING – Indoors and Outdoors**

**UNRHWY BETH SY’N DEBYG I’R HYN SY’N CAEL EI GYNNWYD O FEWN CREU**

**CERDDORIAETH NEU DAWNSIO - Dan Do a Ty Fas / ANYTHING of SIMILAIR DESCRIPTION to MAKING MUSIC or DANCING – Indoors and Outdoors**

**DARPARU LLUNIAETH POETH YN HWYR YN Y NOS – Dan Do /PROVISION OF LATE NIGHT REFRESHMENT - Indoors**

**CYFLEWNI ALCOHOL – Ar ac Oddi Ar y Safle / SALE BY RETAIL OF ALCOHOL – On and Off Sales**

**Yr amseroedd y mae'r drwydded yn caniatáu cynnal gweithgareddau trwyddedadwy**  
**The times the licence authorises the carrying out of licensable activities**

**ADLONIAINT WEDI EI REOLEIDDIO / REGULATED ENTERTAINMENT**

**FFILMIAU – Dan Do / FILMS – Indoors: LLUN – SUL / MON – SUN 0900hrs – 0230hrs**

**DRAMAU – Dan Do - PLAYS - Indoors**

**CHWARAEON DAN DO / INDOOR SPORTING EVENTS**

**ADLONIAINT PAFFIO NEU RESLO – Dan Do / BOXING OR WRESTLING - Indoors**

**CERDDORIAETH BYW – Dan Do / LIVE MUSIC – Indoors and Outdoors**

**CERDDORIAETH WEDI RECORDIO – Dan Do - RECORDED MUSIC – Indoors and Outdoors**

**UNRHYW BETH SY'N DEBYG I'R HYN SY'N CAEL EI GYNNWYS O FEWN CERDDORIAETH FYW,**

**CERDDORIAETH WEDI EI RECORDIO NEU PERFFORMIADAU DAWNS – Dan Do / ANYTHING of SIMILAIR DESCRIPTION TO LIVE or RECORDED MUSIC or PERFORMANCES of DANCE – Indoors and Outdoors**

**PERFFORMIADAU DAWNS – Dan Do - PERFORMANCES OF DANCE – Indoors and Outdoors**

**GWEITHGREDDAU UCHOD / ALL ABOVE ACTIVITIES**

**LLUN – SUL / MON – SUN: 1000hrs – 0100hrs**

**CYFLEUSTERAU AR GYFER ADLONIAINT / FACILITIES for ENTERTAINMENT:**

**CREU CERDDORIAETH – Dan Do a Ty Fas / MAKING MUSIC – Indoors and Outdoors**

**DAWNSIO – Dan Do a Ty Fas / DANCING – Indoors and Outdoors**

**UNRHWY BETH SY'N DEBYG I'R HYN SY'N CAEL EI GYNNWYD O FEWN CREU**

**CERDDORIAETH NEU DAWNSIO - Dan Do a Ty Fas / ANYTHING of SIMILAIR DESCRIPTION to MAKING MUSIC or DANCING – Indoors and Outdoors**

**LLUN – SUL 24 awr argaeledd // MON – SUN: 24hr Availability**

**DARPARU LLUNIETH POETH YN HYWR YN Y NOS – Dan Do / LATE NIGHT REFRESHMENT –**

**Indoors: LLUN – SUL / MON – SUN: 2300hrs – 0230hrs**

**CYFLEWNI ALOCHOL – Ar ac Oddi Ar Y Safle / SALE BY RETAIL OF ALCOHOL – On and Off Sales:**

**LLUN – SUL / MON – SUN: 1100hrs – 0100hrs**

**AMSERA ANSAFONOL: NOSON CALAN GAEAF: O ddechrau oriau Nos Galan Gaeaf tan ddiwedd oriau ar Ionawr 1af. Yn ddilys i'r holl gweithgareddau uchod.**

**NON STANDARD TIMING: New Years Eve:- From commencement of hours on New Years Eve to conclusion of hours on the following day. Applies to all above activities.**

**Oriau agor y safle | The opening hours of the premises**

**LLUN – SUL / MON – SUN: 0730hrs – 0300hrs**

**AMSERAU ANSAFONOL: NOSON CALAN GAEAF: O ddechrau oriau Nos Galan Gaeaf tan ddiwedd oriau ar Ionawr 1af.**

**NON STANDARD TIMINGS: New Years Eve:- From commencement of hours New Years Eve to conclusion of hours following day.**

**Os yw'r drwydded yn caniatáu cyflenwi alcohol, a yw hyn yn golygu ar gyfer yfed ar y safle neu oddi yno**

**Where the licence authorises supplies of alcohol whether these are on and/ or off supplies**

**AR AC ODDI AR Y SAFLE | ON AND OFF SALES**

**Enw, cyfeiriad (cofrestredig), rhif ffôn ac e-bost (os yw'n berthnasol) deilydd y drwydded safle | Name, (registered) address, telephone number and email (where relevant) of holder of premises licence**

**THEATR MWLDAN,  
BATH HOUSE ROAD,  
CARDIGAN.  
SA43 1JY  
tel. 01239 621200  
[ryan@mwldan.co.uk](mailto:ryan@mwldan.co.uk)**

**Rhif cofrestredig y deilydd, er enghraifft rhif cwmni, rhif elusen (os yw'n berthnasol) Registered number of holder, for example company number, charity number (where applicable)**

**2701986**

**Enw, cyfeiriad a rhif ffôn Goruchwyliwr Safle dynodedig os yw'r drwydded safle yn caniatáu cyflenwi alcohol | Name, address and telephone number of designated premises supervisor where the premises licence authorises the supply of alcohol**

**JASMINE REVELL**

**Rhif trwydded bersonol ac enw'r awdurdod sy'n rhoi'r drwydded bersonol a ddelir gan y Goruchwyliwr Safle dynodedig os yw'r drwydded safle yn caniatáu cyflenwi alcohol Personal licence number and issuing authority of personal licence held by designated premises supervisor where the premises licence authorises for the supply of alcohol**

**OONU-IND-03369**

**CYNGOR SIR CAERFYRDDIN / CARMARTHENSHIRE COUNTY COUNCIL**

## **ATODIAD 1 - AMODAU GORFODOL**

### **1 Amodau gorfodol pan fydd trwydded yn awdurdodi cyflenwi alcohol**

- (1) Pan fydd trwydded safle'n awdurdodi cyflenwi alcohol, rhaid i'r drwydded gynnwys yr amodau canlynol.
- (2) Yr amod cyntaf yw na ellir cyflenwi alcohol dan y drwydded safle-
  - (a) ar adeg pan nad oes yna oruchwyliwr safle dynodedig yn unol â'r drwydded safle, neu
  - (b) ar adeg pan nad oes gan y goruchwyliwr safle dynodedig drwydded bersonol neu pan fydd ei drwydded bersonol wedi'i hatal.
- (3) Yr ail amod yw bod unrhyw alcohol a gyflenwir dan y drwydded safle'n gorfod cael ei gyflenwi neu'i awdurdodi gan berson sydd â thrwydded bersonol.

### **2 Amod gorfodol: dangos ffilmiau**

- (1) Pan fydd trwydded safle'n awdurdodi dangos ffilmiau, rhaid i'r drwydded gynnwys amod bod mynediad i blant pan fydd unrhyw ffilm yn cael ei dangos yn cael ei gyfyngu yn unol â'r adran hon.
- (2) Pan fydd y corff categoreiddio ffilmiau'n cael ei nodi yn y drwydded, oni bai bod is-adran (3)(b) yn berthnasol, rhaid cyfyngu mynediad i blant yn unol ag unrhyw argymhelliad a wneir gan y corff hwnnw.
- (3)
  - (a) pan nad yw'r corff categoreiddio ffilmiau wedi'i nodi yn y drwydded, neu
  - (b) pan fydd yr awdurdod trwyddedu wedi hysbysu deiliad y drwydded bod yr is-adran hon yn berthnasol i'r ffilm dan sylw, dylid cyfyngu mynediad i blant yn unol ag unrhyw argymhelliad a wneir gan yr awdurdod trwyddedu hwnnw.
- (4) Yn yr adran hon -  
Mae "plant" yn golygu pobl dan 18 oed; ac mae "corff categoreiddio ffilmiau" yn golygu'r person neu'r personau a ddynodwyd fel yr awdurdod dan adran 4 o Ddeddf Recordiadau Fideo 1984 (c.39) (yr awdurdod sy'n pennu addasrwydd ffilmiau fideo ar gyfer categoreiddio).

### **3 Amod gorfodol: goruchwyllo drysau**

- (1) Pan fydd trwydded safle'n cynnwys amod bod yn rhaid i un berson neu ragor fod ar yr eiddo ar adegau penodol i gwblhau gweithgaredd diogelwch, rhaid i'r drwydded gynnwys amod bod yn rhaid i unrhyw berson o'r fath feddu ar drwydded Awdurdod y Diwydiant Diogelwch.
- (2) Ond does dim byd yn is-adran (1) sy'n gofyn am osod amod o'r fath -
  - (a) ar gyfer safleoedd o fewn paragraff 8(3)(a) o Atodlen 2 Deddf y Diwydiant Diogelwch Preifat 2001 (c.12) (safleoedd gyda thrwyddedau safle sy'n awdurdodi dramâu neu ffilmiau, neu
  - (b) ar gyfer safleoedd mewn perthynas ag-
    - (i) unrhyw achlysur a grybwyllir ym mharagraff 8(3)(b) neu (c) o'r Atodlen honno (safleoedd sy'n cael eu defnyddio gan glwb sydd â thystysgrif safle clwb yn unig, dan hysbysiad digwyddiad dros dro sy'n awdurdodi dramâu neu ffilmiau, neu dan drwydded hapchwarae, neu
    - (ii) unrhyw achlysur o fewn paragraff 8(3)(d) o'r Atodlen honno (achlysuron a bennir gan reoliadau dan y Ddeddf honno).
- (3) At ddibenion yr adran hon -
  - (a) mae "gweithgaredd diogelwch" yn golygu gweithgaredd y mae paragraff 2(1)(a) o'r Atodlen honno'n berthnasol ar ei gyfer, a

(b) bod paragraff 8(5) o'r Atodlen honno (dehongli cyfeiriadau at achlysur) yn berthnasol, am ei fod yn berthnasol mewn perthynas â pharagraff 8 o'r Atodlen honno.

### **Gorchymyn Deddf Trwyddedu 2003 (Amodau Trwyddedu Gorfodol) 2014**

#### **Yn effeithiol o 6 Ebrill 2014**

1. Rhaid i berson perthnasol sicrhau na chaiff unrhyw alcohol ei werthu na'i gyflenwi i'w yfed ar y safle nac oddi arno am bris sy'n llai na'r pris a ganiateir.
2. At ddibenion yr amod a nodir ym mharagraff 1-
  - (a) mae "treth" i'w dehongli yn unol â Deddf Trethi ar Ddiodydd Alcoholaidd 1979(6);
  - (b) "y pris a ganiateir" yw'r pris a geir drwy ddefnyddio'r fformiwla –
$$P = D + (D \times V)$$
pan mai –
    - (i) P yw'r pris a ganiateir
    - (ii) D yw cyfradd y dreth sy'n daladwy mewn perthynas â'r alcohol fel pe bai'r dreth yn cael ei chodi ar ddyddiad gwerthu neu gyflenwi'r alcohol, a
    - (iii) V yw cyfradd y dreth ar werth sy'n daladwy mewn perthynas â'r alcohol fel pe bai'r dreth ar werth yn cael ei chodi ar ddyddiad gwerthu neu gyflenwi'r alcohol
  - (c) ystyr "person perthnasol", mewn perthynas â safle lle y mae trwydded safle mewn grym, yw
    - (i) Deiliad y drwydded safle,
    - (ii) Goruchwylydd dynodedig y safle (os oes un) mewn perthynas â thrwydded o'r fath, neu
    - (iii) Deiliad trwydded bersonol sy'n cyflenwi alcohol o dan drwydded o'r fath neu sy'n caniatáu iddo gael ei gyflenwi;
  - (d) ystyr "person perthnasol", mewn perthynas â safle lle y mae tystysgrif safle clwb mewn grym, yw unrhyw un o aelodau neu swyddogion y clwb sy'n bresennol ar y safle mewn rôl sy'n galluogi'r aelod neu'r swyddog i atal y cyflenwad o dan sylw; ac
  - (e) ystyr "treth ar werth" yw treth ar werth sy'n daladwy yn unol â Deddf Treth ar Werth 1994(7)
3. Os nad yw'r pris a ganiateir a roddir gan Baragraff (b) o baragraff 2 (ar wahân i'r paragraff hwn) yn rhif cyfan o geiniogau, rhaid cymryd mai'r pris a roddir gan yr is-baragraff hwnnw yw'r pris a roddir mewn gwirionedd gan yr is-baragraff hwnnw wedi'i dalgrynnu i fyny i'r geiniog agosaf.
4. (1) Mae is-baragraff (2) yn gymwys os yw'r pris a ganiateir gan Baragraff (b) o baragraff 2 ar y naill ddiwrnod ("y diwrnod cyntaf") yn wahanol i'r pris a ganiateir ar y diwrnod nesaf ("yr ail ddiwrnod") o ganlyniad i newid i gyfradd y dreth neu'r dreth ar werth.  
(2) Mae'r pris a ganiateir sy'n gymwys ar y diwrnod cyntaf yn gymwys i werthiant neu

gyflenwad alcohol sy'n digwydd cyn i'r cyfnod o 14 diwrnod sy'n dechrau ar yr ail ddiwrnod ddod i ben.

### **Gorchymyn Deddf Trwyddedu 2003 (Amodau Trwyddedu Gorfodol) (Diwygio) 2014**

Mae'r Amodau Gorfodol isod yn **disodli** Gorchymyn Deddf Trwyddedu 2003 (Amodau Trwyddedu Gorfodol) 2010 a daethant i rym ar **1 Hydref 2014**.

**Mae amodau 1 i 4 yn cyfeirio at yr holl safleoedd sy'n gwerthu neu gyflenwi alcohol i'w yfed ar y safle. Mae amod 3 yn berthnasol i safleoedd sy'n gwerthu alcohol i'w yfed oddi ar y safle.**

1. (1) Rhaid i'r person cyfrifol sicrhau nad yw staff ar y safle perthnasol yn ymgymryd â, yn trefnu neu'n cymryd rhan mewn unrhyw hyrwyddo anghyfrifol mewn perthynas â'r safle.

(2) Yn y paragraff hwn, mae hyrwyddo anghyfrifol yn golygu un neu fwy o'r gweithgareddau a ganlyn, neu weithgareddau sy'n sylweddol debyg, sy'n digwydd er mwyn hyrwyddo gwerthiant neu gyflenwad o alcohol i'w yfed ar y safle -

(a) gemau neu weithgareddau eraill sy'n gofyn am neu'n hybu, neu sydd wedi'u dylunio i ofyn neu i hybu unigolion i -

(i) yfed swm o alcohol o fewn cyfyngiad amser (heblaw yfed alcohol a werthwyd neu a gyflenwyd ar y safle cyn terfyn y cyfnod y mae'r unigolyn cyfrifol wedi'i awdurdodi i werthu neu gyflenwi alcohol), neu

(ii) yfed cymaint o alcohol â phosib (un ai mewn cyfyngiad amser neu fel arall);

(b) darparu swm diddiwedd neu amhenodol o alcohol am ddim neu am bris penodedig neu ar ddisgownt i'r cyhoedd neu i grŵp a gaiff ei ddiffinio gan nodwedd benodol sy'n peri risg sylweddol o danseilio amcan trwyddedu;

(c) darparu alcohol am ddim neu ar ddisgownt neu unrhyw beth arall fel gwobr i annog neu i wobrwyo prynu ac yfed alcohol dros gyfnod o 24 awr neu lai mewn modd sy'n peri risg sylweddol o danseilio amcan trwyddedu;

(d) gwerthu neu gyflenwi alcohol mewn cysylltiad â phosteri neu bamffledi ar, neu yng nghyffiniau'r safle, a ellir ei ystyried yn rhesymol fel ei fod yn caniatáu, neu'n annog neu'n cyfeirio at effeithiau meddwdod ac ymddygiad gwrthgymdeithasol mewn modd ffafriol;

(e) unigolyn yn tywallt alcohol yn uniongyrchol i geg unigolyn arall (heblaw pan fo unigolyn yn methu yfed heb gymorth oherwydd anabledd).

2. Rhaid i'r unigolyn cyfrifol sicrhau fod dŵr yfed am ddim yn cael ei ddarparu ar gais i gwsmeriaid pan fod hyn ar gael yn rhesymol.

3. (1) Rhaid i ddeilydd y drwydded eiddo neu ddeilydd y dystysgrif eiddo clwb sicrhau y gweithredir polisi gwirio oed ar y safle mewn perthynas â gwerthu neu gyflenwi alcohol.

(2) Rhaid i oruchwyliwr dynodedig y safle mewn perthynas â'r drwydded eiddo sicrhau bod gwerthiant alcohol ar y safle yn digwydd yn unol â'r polisi gwirio oed.

(3) Rhaid i'r polisi fynnu bod unigolion sy'n edrych dan 18 oed i'r person cyfrifol (neu'r oed hŷn a nodir yn y polisi) ddangos ar gais, cyn cael prynu alcohol, tystiolaeth yn cynnwys eu llun, dyddiad geni a naill ai -

(a) marc holograffig, neu

(b) nodwedd uwchfioled.

4. Rhaid i'r unigolyn cyfrifol sicrhau -

(a) os caiff unrhyw un o'r diodydd alcoholig canlynol eu gwerthu neu eu cyflenwi i'w hyfed ar y safle (heblaw am ddiodydd alcohol sy'n cael eu gwerthu neu eu cyflenwi ar ôl eu gwneud yn barod i'w gwerthu mewn cynhwysydd wedi'i gau'n ddiogel), bydd yr alcohol ar werth i gwsmeriaid yn y mesurau a ganlyn -

(i) cwrw neu seidr: ½ pint;

(ii) jin, rym, fodca neu wisgi: 25 ml neu 35 ml; a

(iii) gwin llonydd mewn gwydryn: 125 ml;

(b) caiff y mesurau hyn eu dangos mewn bwydlen, ar restr brisiau neu ddeunydd printiedig arall sydd ar gael i gwsmeriaid ar y safle; a

(c) lle nad yw cwsmer, mewn perthynas â gwerthiant alcohol, yn manylu ar y swm o alcohol i'w werthu, bydd y gwerthwr yn hysbysu'r cwsmer fod y mesurau hyn ar gael.



## **Annex 1 - MANDATORY CONDITIONS**

### **1 Mandatory conditions where licence authorises supply of alcohol**

- (1) Where a premises licence authorises the supply of alcohol, the licence must include the following conditions.
- (2) The first condition is that no supply of alcohol may be made under the premises licence-
  - (a) at a time when there is no designated premises supervisor in respect of the premises licence, or
  - (b) at a time when the designated premises supervisor does not hold a personal licence or his personal licence is suspended.
- (3) The second condition is that every supply of alcohol under the premises licence must be made or authorised by a person who holds a personal licence.

### **2 Mandatory condition: exhibition of films**

- (1) Where a premises licence authorises the exhibition of films, the licence must include a condition requiring the admission of children to the exhibition of any film to be restricted in accordance with this section.
- (2) Where the film classification body is specified in the licence, unless subsection (3)(b) applies, admission of children must be restricted in accordance with any recommendation made by that body.
- (3) Where-
  - (a) the film classification body is not specified in the licence, or
  - (b) the relevant licensing authority has notified the holder of the licence that this subsection applies to the film in question, admission of children must be restricted in accordance with any recommendation made by that licensing authority.
- (4) In this section - "children" means persons aged under 18; and "film classification body" means the person or persons designated as the authority under section 4 of the Video Recordings Act 1984 (c.39) (authority to determine suitability of video works for classification).

### **3 Mandatory condition: door supervision**

- (1) Where a premises licence includes a condition that at specified times one or more individuals must be at the premises to carry out a security activity, the licence must include a condition that each such individual must be licensed by the Security Industry Authority.
- (2) But nothing in subsection (1) requires such a condition to be imposed-
  - (a) in respect of premises within paragraph 8(3)(a) of Schedule 2 to the Private Security Industry Act 2001 (c.12) (premises with premises licenses authorising plays or films), or
  - (b) in respect of premises in relation to-
    - (i) any occasion mentioned in paragraph 8(3)(b) or (c) of that Schedule (premises being used exclusively by club with club premises certificate, under a temporary event notice authorising plays or films or under a gaming licence), or
    - (ii) any occasion within paragraph 8(3)(d) of that Schedule (occasions prescribed by regulations under that Act).
- (3) For the purposes of this section-

- (a) "security activity" means an activity to which paragraph 2(1)(a) of that Schedule applies, and
- (b) paragraph 8(5) of that Schedule (interpretation of references to an occasion) applies as it applies in relation to paragraph 8 of that Schedule.

**The Licensing Act 2003 (Mandatory Licensing Conditions) Order 2014**

**With effect from 28<sup>th</sup> May 2014**

1. A relevant person shall ensure that no alcohol is sold or supplied for consumption on or off the premises for a price which is less than the permitted price.
2. For the purposes of the condition set out in paragraph 1-
  - (a) "duty" is to be construed in accordance with the Alcoholic Liquor Duties Act 1979;
  - (b) "permitted price" is the price found by applying the formula –
$$P = D + (D \times V)$$
where –
    - (i) P is the permitted price
    - (ii) D is the rate of duty chargeable in relation to the alcohol as if the duty were charged on the date of the sale or supply of the alcohol, and
    - (iii) V is the rate of value added tax chargeable in relation to the alcohol as if the value added tax were charged on the date of the sale or supply of the alcohol
  - (c) "relevant person" means, in relation to premises in respect of which there is in force a premises licence –
    - (i) The holder of the premises licence,
    - (ii) The designated premises supervisor (if any) in respect of such a licence, or
    - (iii) The personal licence holder who makes or authorises a supply of alcohol under such a licence;
  - (d) "relevant person" means, in relation to premises in respect of which there is in force a club premises certificate, any member or officer of the club present on the premises in a capacity which enables the member or officer to prevent the supply in question; and
  - (e) "valued added tax" means value added tax charged in accordance with the Value Added Tax Act 1994
3. Where the permitted price given by Paragraph (b) of paragraph 2 would (apart from this paragraph) not be a whole number of pennies, the price given by that sub-paragraph shall be taken to be the price actually given by that sub-paragraph rounded up to the nearest penny.

4. (1) Sub-paragraph (2) applies where the permitted price by Paragraph (b) of paragraph 2 on a day (“the first day”) would be different from the permitted price on the next day (“the second day”) as a result of a change to the rate of duty or value added tax.

(2) The permitted price which would apply on the first day applies to sales or supplies of alcohol which take place before the expiry of the period of 14 days beginning on the second day.

### **The Licensing Act 2003 (Mandatory Licensing Conditions) (Amendment) Order 2014**

The below Mandatory Conditions **replace** the Licensing Act 2003 (Mandatory Licensing Conditions) Order 2010 and comes into effect **on 1<sup>st</sup> October 2014**

**Conditions 1 to 4 refer to all premises that sell or supply alcohol for consumption on the premises. Condition 3 is relevant to Premises that sell for consumption off the premises.**

1. (1) The responsible person must ensure that staff on relevant premises do not carry out, arrange or participate in any irresponsible promotions in relation to the premises.

(2) In this paragraph, an irresponsible promotion means any one or more of the following activities, or substantially similar activities, carried on for the purpose of encouraging the sale or supply of alcohol for consumption on the premises—

(a) games or other activities which require or encourage, or are designed to require or encourage, individuals to—

(i) drink a quantity of alcohol within a time limit (other than to drink alcohol sold or supplied on the premises before the cessation of the period in which the responsible person is authorised to sell or supply alcohol), or

(ii) drink as much alcohol as possible (whether within a time limit or otherwise);

(b) provision of unlimited or unspecified quantities of alcohol free or for a fixed or discounted fee to the public or to a group defined by a particular characteristic in a manner which carries a significant risk of undermining a licensing objective;

(c) provision of free or discounted alcohol or any other thing as a prize to encourage or reward the purchase and consumption of alcohol over a period of 24 hours or less in a manner which carries a significant risk of undermining a licensing objective;

(d) selling or supplying alcohol in association with promotional posters or flyers on, or in the vicinity of, the premises which can reasonably be considered to condone, encourage or glamorise anti-social behaviour or to refer to the effects of drunkenness in any favourable manner;

(e) dispensing alcohol directly by one person into the mouth of another (other than where that other person is unable to drink without assistance by reason of disability).

2. The responsible person must ensure that free potable water is provided on request to customers where it is reasonably available.

3. (1) The premises licence holder or club premises certificate holder must ensure that an age verification policy is adopted in respect of the premises in relation to the sale or supply of alcohol.

(2) The designated premises supervisor in relation to the premises licence must ensure that the supply of alcohol at the premises is carried on in accordance with the age verification policy.

(3) The policy must require individuals who appear to the responsible person to be under 18 years of age (or such older age as may be specified in the policy) to produce on request, before being served alcohol, identification bearing their photograph, date of birth and either—

- (a) a holographic mark, or
- (b) an ultraviolet feature.

**4.** The responsible person must ensure that—

(a) where any of the following alcoholic drinks is sold or supplied for consumption on the premises (other than alcoholic drinks sold or supplied having been made up in advance ready for sale or supply in a securely closed container) it is available to customers in the following measures—

- (i) beer or cider: ½ pint;
- (ii) gin, rum, vodka or whisky: 25 ml or 35 ml; and
- (iii) still wine in a glass: 125 ml;

(b) these measures are displayed in a menu, price list or other printed material which is available to customers on the premises; and

(c) where a customer does not in relation to a sale of alcohol specify the quantity of alcohol to be sold, the customer is made aware that these measures are available.”

## Atodiad 2 – Amodau sy'n gyson â'r Rhestr weithredu

### Atal Troseddau ac Anhrefn

- Bydd staff Theatr Mwldan yn dilyn yr arferion gwaith a osodir ym Mholisi Iechyd a Diogelwch Theatr Mwldan.
- Mae staff Theatr Mwldan, os yn ansicr ynghylch oedran cwsmer, wedi cael cyfarwyddyd i beidio â'i serfio ag alcohol heb ofyn am weld dogfen prawf oedran ddilys sy'n cynnwys llun.
- Mae staff Theatr Mwldan wedi cael cyfarwyddyd i fod yn wylidwrs er mwyn atal unrhyw gam-drin neu ddelio mewn cyffuriau.
- Nid yw Theatr Mwldan wedi, ac nid yw'n bwriadu, cynnal unrhyw ymgyrch anghyfrifol i hyrwyddo diodydd rhad.
- Mae'r holl ardaloedd allanol wedi'u goleuo'n dda.
- Bydd Theatr Mwldan yn darparu delweddau CCTV yn unol â gofynion safonol Heddlu Dyfed Powys o bob mynedfa ac allanfa, ac ardaloedd y cyntedd a'r grisiau – i fod ar waith o fewn pedwar mis o'r cais hwn.
- Mae botymau panig wedi'u gosod ger y ddesg yn nerbynfa blaen y tŷ, ger y bar, ac yn uned fanwerthu'r Ganolfan Groeso, sydd wedi'u cysylltu'n uniongyrchol â Chanolfan Derbyn Galwadau Larwm.
- Mae cloeon gydag allweddi magnetig neu allweddi pad wedi'u gosod yn rhannau'r safle nad ydynt ar agor i'r cyhoedd.
- Mae Theatr Mwldan yn defnyddio goruchwylwyr drysau SIA trwyddedig ar gyfer digwyddiadau achlysurol sy'n rhan o raglen y theatr.
- Mae tiliau arian Theatr Mwldan yn rhai diogel.
- Mae'r Ganolfan Groeso a Chegin Caffi Mwldan yn unedau diogel o fewn y lleoliad y tu allan i'r oriau agor dynodedig.

### Diogelwch Cyhoeddus

- Mae gan Theatr Mwldan drefn/rhestr wirio ddyddiol ar gyfer ardal Blaen y Tŷ a Chefn y Llwyfan, sy'n cael ei chwblhau gan y Rheolwyr/Technegwyr ar Ddyletswydd. Mae'r drefn hon yn golygu bod modd delio ag unrhyw broblemau cyn caniatáu mynediad i'r cyhoedd, ac mae'n darparu llwybr awdit ar gyfer staff Theatr Mwldan.
- Mae gan Theatr Mwldan system larwm tân soffistigedig, sef Vigilion V3, sydd wedi'i chysylltu'n uniongyrchol â Chanolfan Derbyn Galwadau Larwm.
- Mae holl staff Theatr Mwldan wedi cael cyfarwyddyd ar Gynllun Gwacau'r Safle mewn Argyfwng Tân, a'r Polisi Iechyd a Diogelwch. Mae Hysbysiadau yn nodi camau gweithredu a mannau ymgynnull os bydd tân wedi'u harddangos ym mhob rhan o'r adeilad.
- Mae'r holl Allanfeydd Tân wedi'u nodi'n glir, ac mae diffoddwyr tân wedi'u lleoli ymhob rhan o'r adeilad (cynllun ynghlwm).
- Mae staff Theatr Mwldan wedi cael cyfarwyddyd i sicrhau bod y fynedfa ar gyfer cerbydau argyfwng yn cael ei chadw'n glir bob amser.

- Gosodwyd uchafswm niferoedd ar gyfer yr awditoria a chedwir atynt bob amser:

Mwldan 1	Seddi sefydlog	146
Mwldan 2	Seddi sefydlog	250
Mwldan 2	Sefyll - fformat hollt	173
Mwldan 2	Sefyll – fformat hollt gyda estyniad llwyfan	137
Mwldan 2	Seddi sefydlog - fformat hollt	128
Mwldan 3	Seddi sefydlog	101

(Cyhoeddwyd | Issued : 31/01/2025)

- Mae staff tîm ar ddyletswydd Theatr Mwldan yn hawdd eu hadnabod am eu bod yn gwisgo crysau gwisg y theatr.
- Mae aelodau o staff Theatr Mwldan yn meddu ar dystysgrifau cyfredol Cymorth Cyntaf yn y Gweithle.
- Mae gan Theatr Mwldan Gyfarpar Diffibrilio Allanol Awtomatig a staff sydd wedi'u hyfforddi i'w ddefnyddio.
- Mae'r lleoliad yn cael ei reoli'n effeithiol ac effeithlon bob amser.

### **Atal Niwsans Cyhoeddus**

- Ni chaniateir mynediad i bobl feddw, dreisgar, cwerylgar neu afreolus. Petai rhywun yn digwydd mynd yn feddw, treisgar, cwerylgar neu afreolus, byddent yn cael eu tywys o'r safle, a byddai'r Heddlu'n cael eu hysbysu.
- Mae mesurau atal sŵn yn eu lle h.y. mae amserau gorffen yn cael eu hamrywio'n ddyddiol yn unol â'r rhaglen er mwyn caniatáu i gynulleidfaoedd wasgaru ar adegau amrywiol.
- Mae lefel y sŵn yn cael ei fonitro i'w gadw o fewn lefel diogel trwy gydol perfformiadau cerddoriaeth fyw perthnasol
- Ni chaniateir unrhyw adloniant allanol ar ôl 2100.

### **Amddiffyn Plant rhag Niwed**

- Mae gan Theatr Mwldan bolisi Amddiffyn Plant ar waith (sydd ar gael ar y safle).
- Bydd aelodau staff yn gofyn am brawf oedran pan fo'n briodol.
- Rhaid i oedolion sy'n rhedeg dosbarthiadau i bobl ifanc dan 18 oed gael gwiriad manwl cyfredol yr SCT, a bydd copi o hwnnw gan Reolwr Cyffredinol Theatr Mwldan.
- Mae staff wedi cael cyfarwyddyd drwy'r Polisi Amddiffyn Plant i fod yn wylidwrus ynghylch lles plant ar y safle, ac maent wedi'u cynghori i roi gwybod i'r Rheolwr ar Ddyletswydd am unrhyw bryderon sydd ganddynt.
- Mae seddi diogel e.e. cadeiriau uchel ar gael i fabanod a phlant bach.
- Mae cyfleusterau newid cewynnau gyda biniau addas ar gyfer gwastraff budr a dŵr tap poeth ac oer ar gael.
- Mae staff wedi cael cyfarwyddyd ynghylch problemau posib sy'n gysylltiedig â chyflenwi/defnyddio cyffuriau peryglus.
- Mae'r holl staff wedi cael cyfarwyddyd ar Gynllun Gwacau Theatr Mwldan mewn Argyfwng Tân a'r Polisi Iechyd a Diogelwch.

## Annex 2 - Conditions consistent with the operating Schedule

### Prevention of Crime and Disorder

- Theatr Mwldan staff follow the work practices set down in Theatr Mwldan's Health and Safety Policy
- Theatr Mwldan staff if uncertain of a customer's age, are instructed not to serve alcohol unless a photographic proof of age document is produced and accepted as genuine proof.
- Theatr Mwldan staff are instructed to be vigilant to combat drug dealing and drug abuse
- Theatr Mwldan has not and will not engage in irresponsible drinks promotion
- All exterior areas are well lit
- Theatr Mwldan will provide CCTV footage to Dyfed Powys Police standard requirements of entrance and exit points, foyer areas and stairs to be operational within four months of this application
- Theatr Mwldan has panic buttons installed at the reception desk in front of house, at the bar and in the Tourist Information Centre retail unit directly linked to an Alarm Call Centre
- Venue areas not open to the general public are fitted with magnetic key locks or key pads.
- Theatr Mwldan uses licensed SIA doorpersons for occasional programmed events when appropriate.
- Theatr Mwldan cash registers are secure.
- The Tourist Information Centre and Caffi Mwldan Kitchen are secure units within the venue outside the designated opening hours.

### Public Safety

- Theatr Mwldan has a daily check-list system for both Front of House areas and Backstage that are completed by the Duty Managers and Duty Technicians. This system allows and daily issues to be remedied before the public are admitted and provides an audit trail for Theatr Mwldan staff.
- Theatr Mwldan has a Vigilion V3 Advanced Fire Detection and Alarm system installed directly linked to an Alarm Call Centre
- All Theatr Mwldan staff have received instruction regarding Theatr Mwldan's Fire Evacuation Plan and Health and Safety Policy. Fire Action Notices detailing the assembly points are displayed throughout the building.
- All Fire Exits are clearly marked, fire extinguishers are positioned throughout the building (plan attached).
- Theatr Mwldan staff are instructed to ensure emergency vehicular access is at all times kept clear.
- Auditoria Capacity numbers have been set and are rigorously enforced:-

Mwldan 1	Fixed seating	146
Mwldan 2	Fixed seating	250
Mwldan 2	Split format standing	173
Mwldan 2	Split format standing with stage extension	137
Mwldan 2	Split format fixed seating	128
Mwldan 3	Fixed seating	101
- Theatr Mwldan duty team staff are easily identified by in-house uniform shirts
- There are members of Theatr Mwldan staff duty who hold current First Aid in the Work Place certificates
- Theatr Mwldan is equipped with an Automated External Defibrillator supported by trained staff

- The venue is managed effectively and efficiently at all times.

### **Prevention of Public Nuisance**

- Drunk, violent, quarrelsome or disorderly persons will not be permitted to enter the premises. In the unlikely event of someone becoming drunk, violent, quarrelsome or disorderly they would be removed from the premises and the Police informed
- Noise prevention measures are in place i.e. differing finishing times apply daily according to the programme allowing audiences to disperse at varying times
- Noise levels are monitored to keep within safe levels throughout relevant live music performances
- No outside entertainment after 21:00 hours

### **Protection of Children from Harm**

- Theatr Mwldan has a Child Protection Policy in place (available in premises)
- Proof of age will be requested, when appropriate by member of staff.
- Adults running classes for young adults under the age of 18 must hold a current Enhanced Criminal Bureau Record check, a copy of which is lodged with the Theatr Mwldan General Manager
- Staff have been instructed via the Child Protection Policy to be vigilant for the welfare of children on the premises, they are advised to inform the Duty Manager if they suspect anything untoward.
- Safe seating e.g high chairs are available for babies and very young children
- Nappy changing facilities with suitable containers for soiled waste and hot and cold running water is available
- Staff have received instruction regarding potential problems associated with the supply/use of dangerous drugs
- All staff have received instruction regarding Theatr Mwldan's Fire Evacuation Plan and Health and Safety Policy.



**Atodiad 3 – Amodau yn atodedig yn sgil gwrandawriad gan yr awdurdod trwyddedu/cyfarfod cyfryngu**

**Annex 3 - Conditions attached after a hearing by the licensing authority/ Mediation meeting**

Atodiad 4 – Cynlluniau | Annex 4 – Plans

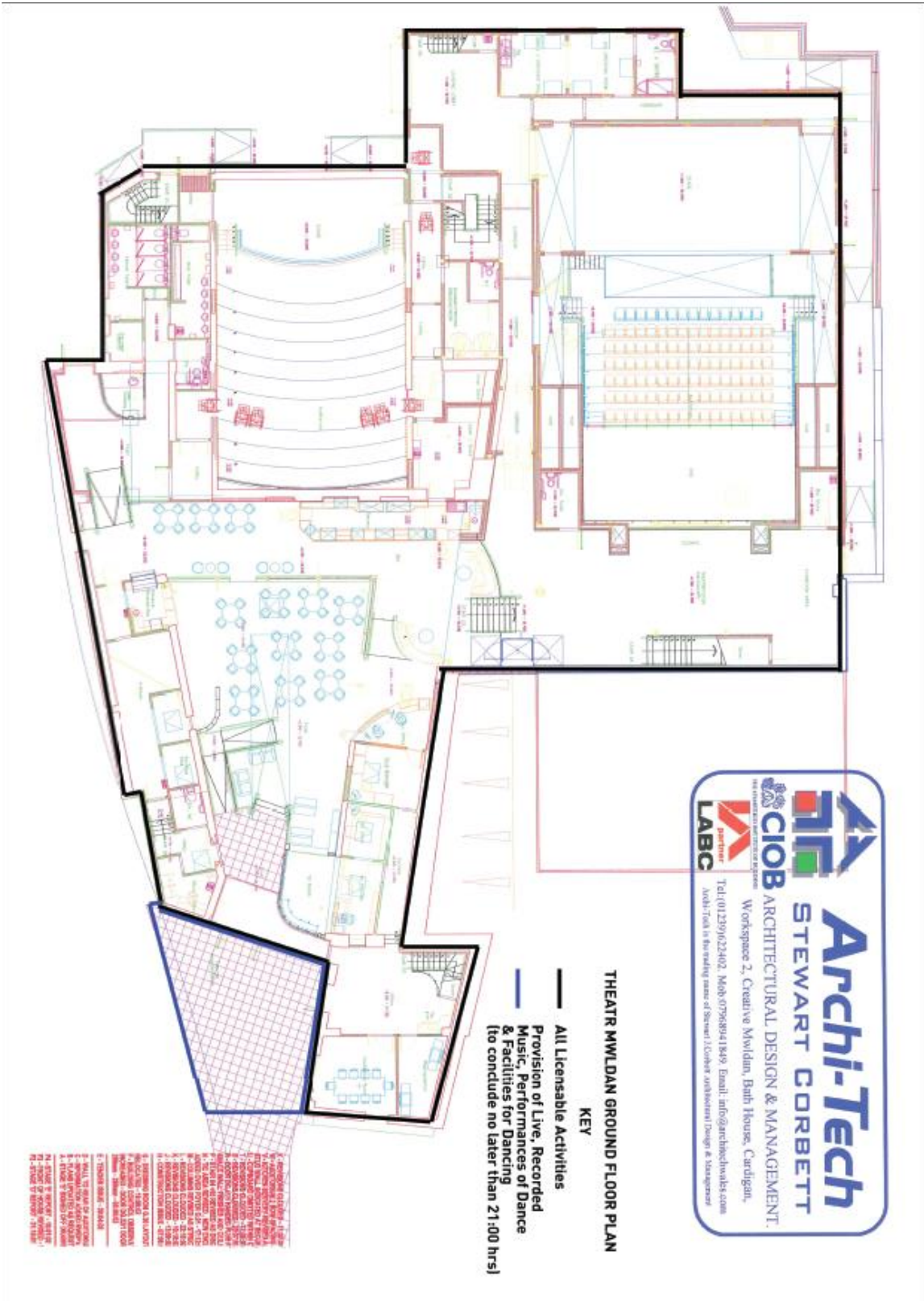

**Archi-Tech**  
**STEWART CORBETT**  
 ARCHITECTURAL DESIGN & MANAGEMENT.  
 Workspace 2, Creative Mwdlan, Bath House, Cardigan.  
 Tel: 01209 602402, Mob: 07968941849, Email: info@architechtd.co.uk  
 Archi-Tech is the trading name of Stewart Corbett Architectural Design & Management  
**LABC** **CIOB** **Partners**

**THEATR MWLDAN GROUND FLOOR PLAN**  
**KEY**  
 — All Licensable Activities  
 — Provision of Live, Recorded Music, Performances of Dance & Facilities for Dancing (to conclude no later than 21:00 hrs)

- 1. RECEPTION AREA
- 2. WAITING AREA
- 3. TICKETS
- 4. BAR
- 5. RESTROOMS
- 6. STAIRS
- 7. OFFICES
- 8. STORAGE
- 9. TECHNICAL
- 10. LOBBY
- 11. STAGE
- 12. SEATING
- 13. BACKSTAGE
- 14. MECHANICAL
- 15. ELECTRICAL
- 16. PLUMBING
- 17. GLASS
- 18. METAL
- 19. CONCRETE
- 20. WOOD
- 21. PAINT
- 22. LIGHTING
- 23. SOUND
- 24. VIDEO
- 25. TELEVISION
- 26. AUDIO
- 27. NETWORKING
- 28. SECURITY
- 29. FIRE
- 30. SAFETY
- 31. ACCESSIBILITY
- 32. SIGNAGE
- 33. FURNITURE
- 34. DECORATION
- 35. LANDSCAPE
- 36. EXTERIOR
- 37. ROOF
- 38. FOUNDATION
- 39. STRUCTURE
- 40. UTILITIES
- 41. SERVICES
- 42. VENTILATION
- 43. CLIMATE CONTROL
- 44. INSULATION
- 45. GLAZING
- 46. WINDOWS
- 47. DOORS
- 48. RAILINGS
- 49. HANDRAILS
- 50. ESCAPE ROUTES
- 51. EXIT SIGNS
- 52. FIRST AID
- 53. FIRE EXTINGUISHERS
- 54. EMERGENCY LIGHTS
- 55. SECURITY SYSTEMS
- 56. ACCESS CONTROL
- 57. CCTV
- 58. INTERCOM
- 59. VOIP
- 60. WIRELESS
- 61. CLOUD
- 62. MOBILE
- 63. TABLETS
- 64. SMART
- 65. IOT
- 66. DATA
- 67. ANALYTICS
- 68. AI
- 69. ML
- 70. DL
- 71. RL
- 72. NLP
- 73. CV
- 74. OCR
- 75. RPA
- 76. BPM
- 77. ERP
- 78. CRM
- 79. HRM
- 80. SCM
- 81. PLM
- 82. ERM
- 83. GRC
- 84. IAM
- 85. SSO
- 86. MFA
- 87. PAM
- 88. DPA
- 89. GDPR
- 90. ISO
- 91. SAS
- 92. SaaS
- 93. PaaS
- 94. IaaS
- 95. FaaS
- 96. Serverless
- 97. Containers
- 98. Kubernetes
- 99. Docker
- 100. Jenkins
- 101. Git
- 102. GitHub
- 103. GitLab
- 104. Bitbucket
- 105. CircleCI
- 106. TravisCI
- 107. Heroku
- 108. AWS
- 109. Azure
- 110. GCP
- 111. Oracle
- 112. IBM
- 113. SAP
- 114. Salesforce
- 115. Microsoft
- 116. Adobe
- 117. Oracle
- 118. SAP
- 119. Salesforce
- 120. Microsoft
- 121. Adobe
- 122. Oracle
- 123. SAP
- 124. Salesforce
- 125. Microsoft
- 126. Adobe
- 127. Oracle
- 128. SAP
- 129. Salesforce
- 130. Microsoft
- 131. Adobe
- 132. Oracle
- 133. SAP
- 134. Salesforce
- 135. Microsoft
- 136. Adobe
- 137. Oracle
- 138. SAP
- 139. Salesforce
- 140. Microsoft
- 141. Adobe
- 142. Oracle
- 143. SAP
- 144. Salesforce
- 145. Microsoft
- 146. Adobe
- 147. Oracle
- 148. SAP
- 149. Salesforce
- 150. Microsoft
- 151. Adobe
- 152. Oracle
- 153. SAP
- 154. Salesforce
- 155. Microsoft
- 156. Adobe
- 157. Oracle
- 158. SAP
- 159. Salesforce
- 160. Microsoft
- 161. Adobe
- 162. Oracle
- 163. SAP
- 164. Salesforce
- 165. Microsoft
- 166. Adobe
- 167. Oracle
- 168. SAP
- 169. Salesforce
- 170. Microsoft
- 171. Adobe
- 172. Oracle
- 173. SAP
- 174. Salesforce
- 175. Microsoft
- 176. Adobe
- 177. Oracle
- 178. SAP
- 179. Salesforce
- 180. Microsoft
- 181. Adobe
- 182. Oracle
- 183. SAP
- 184. Salesforce
- 185. Microsoft
- 186. Adobe
- 187. Oracle
- 188. SAP
- 189. Salesforce
- 190. Microsoft
- 191. Adobe
- 192. Oracle
- 193. SAP
- 194. Salesforce
- 195. Microsoft
- 196. Adobe
- 197. Oracle
- 198. SAP
- 199. Salesforce
- 200. Microsoft
- 201. Adobe
- 202. Oracle
- 203. SAP
- 204. Salesforce
- 205. Microsoft
- 206. Adobe
- 207. Oracle
- 208. SAP
- 209. Salesforce
- 210. Microsoft
- 211. Adobe
- 212. Oracle
- 213. SAP
- 214. Salesforce
- 215. Microsoft
- 216. Adobe
- 217. Oracle
- 218. SAP
- 219. Salesforce
- 220. Microsoft
- 221. Adobe
- 222. Oracle
- 223. SAP
- 224. Salesforce
- 225. Microsoft
- 226. Adobe
- 227. Oracle
- 228. SAP
- 229. Salesforce
- 230. Microsoft
- 231. Adobe
- 232. Oracle
- 233. SAP
- 234. Salesforce
- 235. Microsoft
- 236. Adobe
- 237. Oracle
- 238. SAP
- 239. Salesforce
- 240. Microsoft
- 241. Adobe
- 242. Oracle
- 243. SAP
- 244. Salesforce
- 245. Microsoft
- 246. Adobe
- 247. Oracle
- 248. SAP
- 249. Salesforce
- 250. Microsoft
- 251. Adobe
- 252. Oracle
- 253. SAP
- 254. Salesforce
- 255. Microsoft
- 256. Adobe
- 257. Oracle
- 258. SAP
- 259. Salesforce
- 260. Microsoft
- 261. Adobe
- 262. Oracle
- 263. SAP
- 264. Salesforce
- 265. Microsoft
- 266. Adobe
- 267. Oracle
- 268. SAP
- 269. Salesforce
- 270. Microsoft
- 271. Adobe
- 272. Oracle
- 273. SAP
- 274. Salesforce
- 275. Microsoft
- 276. Adobe
- 277. Oracle
- 278. SAP
- 279. Salesforce
- 280. Microsoft
- 281. Adobe
- 282. Oracle
- 283. SAP
- 284. Salesforce
- 285. Microsoft
- 286. Adobe
- 287. Oracle
- 288. SAP
- 289. Salesforce
- 290. Microsoft
- 291. Adobe
- 292. Oracle
- 293. SAP
- 294. Salesforce
- 295. Microsoft
- 296. Adobe
- 297. Oracle
- 298. SAP
- 299. Salesforce
- 300. Microsoft
- 301. Adobe
- 302. Oracle
- 303. SAP
- 304. Salesforce
- 305. Microsoft
- 306. Adobe
- 307. Oracle
- 308. SAP
- 309. Salesforce
- 310. Microsoft
- 311. Adobe
- 312. Oracle
- 313. SAP
- 314. Salesforce
- 315. Microsoft
- 316. Adobe
- 317. Oracle
- 318. SAP
- 319. Salesforce
- 320. Microsoft
- 321. Adobe
- 322. Oracle
- 323. SAP
- 324. Salesforce
- 325. Microsoft
- 326. Adobe
- 327. Oracle
- 328. SAP
- 329. Salesforce
- 330. Microsoft
- 331. Adobe
- 332. Oracle
- 333. SAP
- 334. Salesforce
- 335. Microsoft
- 336. Adobe
- 337. Oracle
- 338. SAP
- 339. Salesforce
- 340. Microsoft
- 341. Adobe
- 342. Oracle
- 343. SAP
- 344. Salesforce
- 345. Microsoft
- 346. Adobe
- 347. Oracle
- 348. SAP
- 349. Salesforce
- 350. Microsoft
- 351. Adobe
- 352. Oracle
- 353. SAP
- 354. Salesforce
- 355. Microsoft
- 356. Adobe
- 357. Oracle
- 358. SAP
- 359. Salesforce
- 360. Microsoft
- 361. Adobe
- 362. Oracle
- 363. SAP
- 364. Salesforce
- 365. Microsoft
- 366. Adobe
- 367. Oracle
- 368. SAP
- 369. Salesforce
- 370. Microsoft
- 371. Adobe
- 372. Oracle
- 373. SAP
- 374. Salesforce
- 375. Microsoft
- 376. Adobe
- 377. Oracle
- 378. SAP
- 379. Salesforce
- 380. Microsoft
- 381. Adobe
- 382. Oracle
- 383. SAP
- 384. Salesforce
- 385. Microsoft
- 386. Adobe
- 387. Oracle
- 388. SAP
- 389. Salesforce
- 390. Microsoft
- 391. Adobe
- 392. Oracle
- 393. SAP
- 394. Salesforce
- 395. Microsoft
- 396. Adobe
- 397. Oracle
- 398. SAP
- 399. Salesforce
- 400. Microsoft
- 401. Adobe
- 402. Oracle
- 403. SAP
- 404. Salesforce
- 405. Microsoft
- 406. Adobe
- 407. Oracle
- 408. SAP
- 409. Salesforce
- 410. Microsoft
- 411. Adobe
- 412. Oracle
- 413. SAP
- 414. Salesforce
- 415. Microsoft
- 416. Adobe
- 417. Oracle
- 418. SAP
- 419. Salesforce
- 420. Microsoft
- 421. Adobe
- 422. Oracle
- 423. SAP
- 424. Salesforce
- 425. Microsoft
- 426. Adobe
- 427. Oracle
- 428. SAP
- 429. Salesforce
- 430. Microsoft
- 431. Adobe
- 432. Oracle
- 433. SAP
- 434. Salesforce
- 435. Microsoft
- 436. Adobe
- 437. Oracle
- 438. SAP
- 439. Salesforce
- 440. Microsoft
- 441. Adobe
- 442. Oracle
- 443. SAP
- 444. Salesforce
- 445. Microsoft
- 446. Adobe
- 447. Oracle
- 448. SAP
- 449. Salesforce
- 450. Microsoft
- 451. Adobe
- 452. Oracle
- 453. SAP
- 454. Salesforce
- 455. Microsoft
- 456. Adobe
- 457. Oracle
- 458. SAP
- 459. Salesforce
- 460. Microsoft
- 461. Adobe
- 462. Oracle
- 463. SAP
- 464. Salesforce
- 465. Microsoft
- 466. Adobe
- 467. Oracle
- 468. SAP
- 469. Salesforce
- 470. Microsoft
- 471. Adobe
- 472. Oracle
- 473. SAP
- 474. Salesforce
- 475. Microsoft
- 476. Adobe
- 477. Oracle
- 478. SAP
- 479. Salesforce
- 480. Microsoft
- 481. Adobe
- 482. Oracle
- 483. SAP
- 484. Salesforce
- 485. Microsoft
- 486. Adobe
- 487. Oracle
- 488. SAP
- 489. Salesforce
- 490. Microsoft
- 491. Adobe
- 492. Oracle
- 493. SAP
- 494. Salesforce
- 495. Microsoft
- 496. Adobe
- 497. Oracle
- 498. SAP
- 499. Salesforce
- 500. Microsoft
- 501. Adobe
- 502. Oracle
- 503. SAP
- 504. Salesforce
- 505. Microsoft
- 506. Adobe
- 507. Oracle
- 508. SAP
- 509. Salesforce
- 510. Microsoft
- 511. Adobe
- 512. Oracle
- 513. SAP
- 514. Salesforce
- 515. Microsoft
- 516. Adobe
- 517. Oracle
- 518. SAP
- 519. Salesforce
- 520. Microsoft
- 521. Adobe
- 522. Oracle
- 523. SAP
- 524. Salesforce
- 525. Microsoft
- 526. Adobe
- 527. Oracle
- 528. SAP
- 529. Salesforce
- 530. Microsoft
- 531. Adobe
- 532. Oracle
- 533. SAP
- 534. Salesforce
- 535. Microsoft
- 536. Adobe
- 537. Oracle
- 538. SAP
- 539. Salesforce
- 540. Microsoft
- 541. Adobe
- 542. Oracle
- 543. SAP
- 544. Salesforce
- 545. Microsoft
- 546. Adobe
- 547. Oracle
- 548. SAP
- 549. Salesforce
- 550. Microsoft
- 551. Adobe
- 552. Oracle
- 553. SAP
- 554. Salesforce
- 555. Microsoft
- 556. Adobe
- 557. Oracle
- 558. SAP
- 559. Salesforce
- 560. Microsoft
- 561. Adobe
- 562. Oracle
- 563. SAP
- 564. Salesforce
- 565. Microsoft
- 566. Adobe
- 567. Oracle
- 568. SAP
- 569. Salesforce
- 570. Microsoft
- 571. Adobe
- 572. Oracle
- 573. SAP
- 574. Salesforce
- 575. Microsoft
- 576. Adobe
- 577. Oracle
- 578. SAP
- 579. Salesforce
- 580. Microsoft
- 581. Adobe
- 582. Oracle
- 583. SAP
- 584. Salesforce
- 585. Microsoft
- 586. Adobe
- 587. Oracle
- 588. SAP
- 589. Salesforce
- 590. Microsoft
- 591. Adobe
- 592. Oracle
- 593. SAP
- 594. Salesforce
- 595. Microsoft
- 596. Adobe
- 597. Oracle
- 598. SAP
- 599. Salesforce
- 600. Microsoft
- 601. Adobe
- 602. Oracle
- 603. SAP
- 604. Salesforce
- 605. Microsoft
- 606. Adobe
- 607. Oracle
- 608. SAP
- 609. Salesforce
- 610. Microsoft
- 611. Adobe
- 612. Oracle
- 613. SAP
- 614. Salesforce
- 615. Microsoft
- 616. Adobe
- 617. Oracle
- 618. SAP
- 619. Salesforce
- 620. Microsoft
- 621. Adobe
- 622. Oracle
- 623. SAP
- 624. Salesforce
- 625. Microsoft
- 626. Adobe
- 627. Oracle
- 628. SAP
- 629. Salesforce
- 630. Microsoft
- 631. Adobe
- 632. Oracle
- 633. SAP
- 634. Salesforce
- 635. Microsoft
- 636. Adobe
- 637. Oracle
- 638. SAP
- 639. Salesforce
- 640. Microsoft
- 641. Adobe
- 642. Oracle
- 643. SAP
- 644. Salesforce
- 645. Microsoft
- 646. Adobe
- 647. Oracle
- 648. SAP
- 649. Salesforce
- 650. Microsoft
- 651. Adobe
- 652. Oracle
- 653. SAP
- 654. Salesforce
- 655. Microsoft
- 656. Adobe
- 657. Oracle
- 658. SAP
- 659. Salesforce
- 660. Microsoft
- 661. Adobe
- 662. Oracle
- 663. SAP
- 664. Salesforce
- 665. Microsoft
- 666. Adobe
- 667. Oracle
- 668. SAP
- 669. Salesforce
- 670. Microsoft
- 671. Adobe
- 672. Oracle
- 673. SAP
- 674. Salesforce
- 675. Microsoft
- 676. Adobe
- 677. Oracle
- 678. SAP
- 679. Salesforce
- 680. Microsoft
- 681. Adobe
- 682. Oracle
- 683. SAP
- 684. Salesforce
- 685. Microsoft
- 686. Adobe
- 687. Oracle
- 688. SAP
- 689. Salesforce
- 690. Microsoft
- 691. Adobe
- 692. Oracle
- 693. SAP
- 694. Salesforce
- 695. Microsoft
- 696. Adobe
- 697. Oracle
- 698. SAP
- 699. Salesforce
- 700. Microsoft
- 701. Adobe
- 702. Oracle
- 703. SAP
- 704. Salesforce
- 705. Microsoft
- 706. Adobe
- 707. Oracle
- 708. SAP
- 709. Salesforce
- 710. Microsoft
- 711. Adobe
- 712. Oracle
- 713. SAP
- 714. Salesforce
- 715. Microsoft
- 716. Adobe
- 717. Oracle
- 718. SAP
- 719. Salesforce
- 720. Microsoft
- 721. Adobe
- 722. Oracle
- 723. SAP
- 724. Salesforce
- 725. Microsoft
- 726. Adobe
- 727. Oracle
- 728. SAP
- 729. Salesforce
- 730. Microsoft
- 731. Adobe
- 732. Oracle
- 733. SAP
- 734. Salesforce
- 735. Microsoft
- 736. Adobe
- 737. Oracle
- 738. SAP
- 739. Salesforce
- 740. Microsoft
- 741. Adobe
- 742. Oracle
- 743. SAP
- 744. Salesforce
- 745. Microsoft
- 746. Adobe
- 747. Oracle
- 748. SAP
- 749. Salesforce
- 750. Microsoft
- 751. Adobe
- 752. Oracle
- 753. SAP
- 754. Salesforce
- 755. Microsoft
- 756. Adobe
- 757. Oracle
- 758. SAP
- 759. Salesforce
- 760. Microsoft
- 761. Adobe
- 762. Oracle
- 763. SAP
- 764. Salesforce
- 765. Microsoft
- 766. Adobe
- 767. Oracle
- 768. SAP
- 769. Salesforce
- 770. Microsoft
- 771. Adobe
- 772. Oracle
- 773. SAP
- 774. Salesforce
- 775. Microsoft
- 776. Adobe
- 777. Oracle
- 778. SAP
- 779. Salesforce
- 780. Microsoft
- 781. Adobe
- 782. Oracle
- 783. SAP
- 784. Salesforce
- 785. Microsoft
- 786. Adobe
- 787. Oracle
- 788. SAP
- 789. Salesforce
- 790. Microsoft
- 791. Adobe
- 792. Oracle
- 793. SAP
- 794. Salesforce
- 795. Microsoft
- 796. Adobe
- 797. Oracle
- 798. SAP
- 799. Salesforce
- 800. Microsoft
- 801. Adobe
- 802. Oracle
- 803. SAP
- 804. Salesforce
- 805. Microsoft
- 806. Adobe
- 807. Oracle
- 808. SAP
- 809. Salesforce
- 810. Microsoft
- 811. Adobe
- 812. Oracle
- 813. SAP
- 814. Salesforce
- 815. Microsoft
- 816. Adobe
- 817. Oracle
- 818. SAP
- 819. Salesforce
- 820. Microsoft
- 821. Adobe
- 822. Oracle
- 823. SAP
- 824. Salesforce
- 825. Microsoft
- 826. Adobe
- 827. Oracle
- 828. SAP
- 829. Salesforce
- 830. Microsoft
- 831. Adobe
- 832. Oracle
- 833. SAP
- 834. Salesforce
- 835. Microsoft
- 836. Adobe
- 837. Oracle
- 838. SAP
- 839. Salesforce
- 840. Microsoft
- 841. Adobe
- 842. Oracle
- 843. SAP
- 844. Salesforce
- 845. Microsoft
- 846. Adobe
- 847. Oracle
- 848. SAP
- 849. Salesforce
- 850. Microsoft
- 851. Adobe
- 852. Oracle
- 853. SAP
- 854. Salesforce
- 855. Microsoft
- 856. Adobe
- 857. Oracle
- 858. SAP
- 859. Salesforce
- 860. Microsoft
- 861. Adobe
- 862. Oracle
- 863. SAP
- 864. Salesforce
- 865. Microsoft
- 866. Adobe
- 867. Oracle
- 868. SAP
- 869. Salesforce
- 870. Microsoft
- 871. Adobe
- 872. Oracle
- 873. SAP
- 874. Salesforce
- 875. Microsoft
- 876. Adobe
- 877. Oracle
- 878. SAP
- 879. Salesforce
- 880. Microsoft
- 881. Adobe
- 882. Oracle
- 883. SAP
- 884. Salesforce
- 885. Microsoft
- 886. Adobe
- 887. Oracle
- 888. SAP
- 889. Salesforce
- 890. Microsoft
- 891. Adobe
- 892. Oracle
- 893. SAP
- 894. Salesforce
- 895. Microsoft
- 896. Adobe
- 897. Oracle
- 898. SAP
- 899. Salesforce
- 900. Microsoft
- 901. Adobe
- 902. Oracle
- 903. SAP
- 904. Salesforce
- 905. Microsoft
- 906. Adobe
- 907. Oracle
- 908. SAP
- 909. Salesforce
- 910. Microsoft
- 911. Adobe
- 912. Oracle
- 913. SAP
- 914. Salesforce
- 915. Microsoft
- 916. Adobe
- 917. Oracle
- 918. SAP
- 919. Salesforce
- 920. Microsoft
- 921. Adobe
- 922. Oracle
- 923. SAP
- 924. Salesforce
- 925. Microsoft
- 926. Adobe
- 927. Oracle
- 928. SAP
- 929. Salesforce
- 930. Microsoft
- 931. Adobe
- 932. Oracle
- 933. SAP
- 934. Salesforce
- 935. Microsoft
- 936. Adobe
- 937. Oracle
- 938. SAP
- 939. Salesforce
- 940. Microsoft
- 941. Adobe
- 942. Oracle
- 943. SAP
- 944. Salesforce
- 945. Microsoft
- 946. Adobe
- 947. Oracle
- 948. SAP
- 949. Salesforce
- 950. Microsoft
- 951. Adobe
- 952. Oracle
- 953. SAP
- 954. Salesforce
- 955. Microsoft
- 956. Adobe
- 957. Oracle
- 958. SAP
- 959. Salesforce
- 960. Microsoft
- 961. Adobe
- 962. Oracle
- 963. SAP
- 964. Salesforce
- 965. Microsoft
- 966. Adobe
- 967. Oracle
- 968. SAP
- 969. Salesforce
- 970. Microsoft
- 971. Adobe
- 972. Oracle
- 973. SAP
- 974. Salesforce
- 975. Microsoft
- 976. Adobe
- 977. Oracle
- 978. SAP
- 979. Salesforce
- 980. Microsoft
- 981. Adobe
- 982. Oracle
- 983. SAP
- 984. Salesforce
- 985. Microsoft
- 986. Adobe
- 987. Oracle
- 988. SAP
- 989. Salesforce
- 990. Microsoft
- 991. Adobe
- 992. Oracle
- 993. SAP
- 994. Salesforce
- 995. Microsoft
- 996. Adobe
- 997. Oracle
- 998. SAP
- 999. Salesforce
- 1000. Microsoft

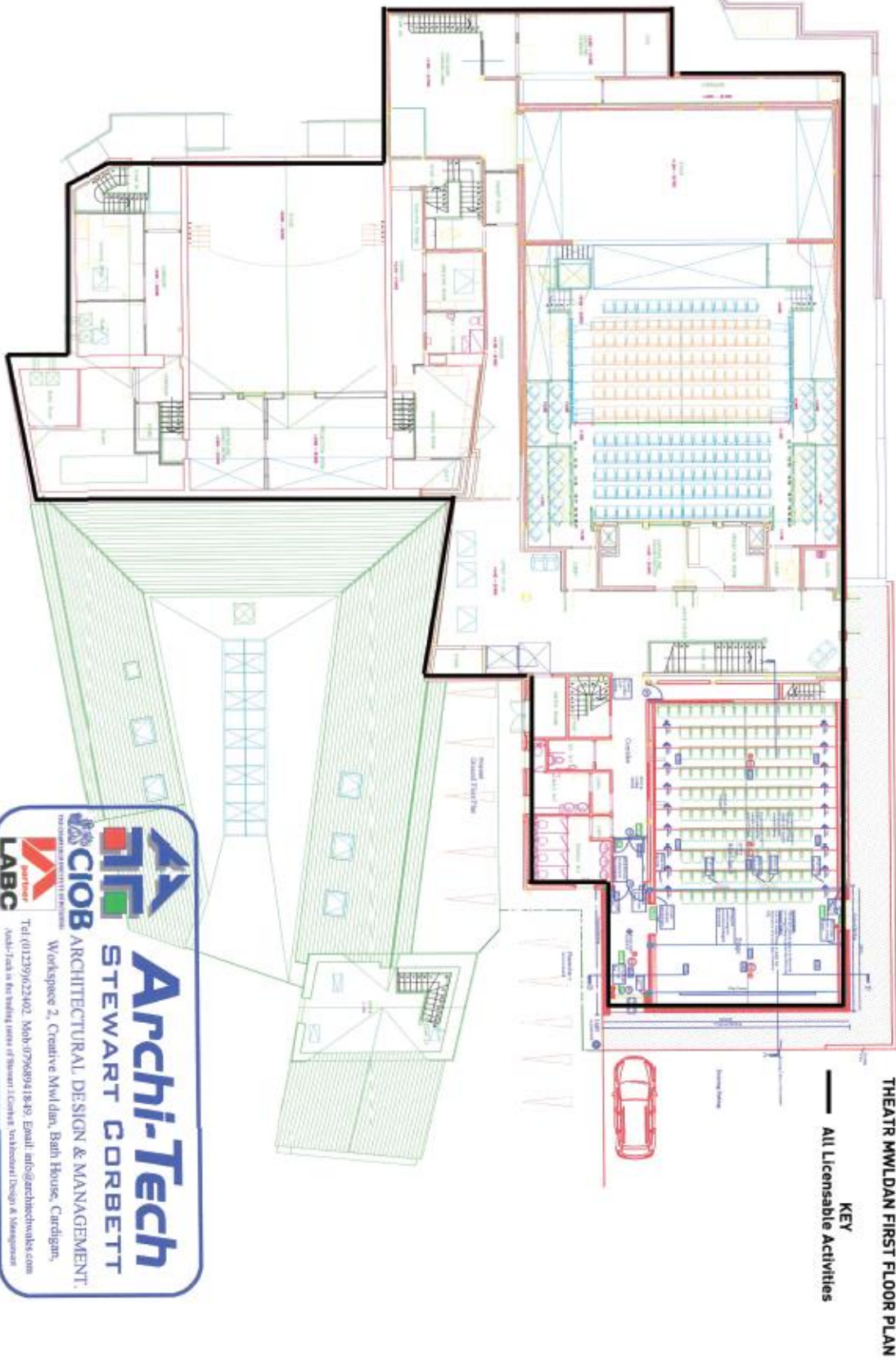

**Archi-Tech**  
**STEWART CORBETT**  
ARCHITECTURAL DESIGN & MANAGEMENT.

**CIOB** ARCHITECTURAL DESIGN & MANAGEMENT  
LABC

Workspace 2, Creative Mwldan, Bath House, Cardigan,  
Tel: (01299) 623402, Mobile: 077968941849, Email: info@architechswales.com  
Archi-Tech is the trading name of Stewart Corbett Architectural Design & Management