

TRAFFIC MANAGEMENT NOTES:
 1) All temporary traffic management shall be in accordance with Chapter 8 of the Traffic Signs Manual.
 2) All temporary traffic management shall be in accordance with the Traffic Signs Regulations and General Directions 2016.
 3) All temporary traffic management shall conform to the Safety at Street Works and Road Works, A Code of Practice.
 4) All signing should be located 450mm minimum from any carriageway.
 5) All temporary traffic management sign locations are indicative and are subject to on site approval from the Engineer.

Key	
	Traffic sign
	Traffic cone
	Pedestrian barrier
	Cone lamp
	Diversion route
	Road closure

Checked by: Adrian Crees	
Customer: MWS LTD	
Job reference: 96730761	
Location: Ty Glyn, Dyffryn Arth, Ceredigion SA48 8DL	QR Code:
Date: 21/01/2025	
Description: Road Closure	
Scale: NTS	OS HA: 0
0330 043 3030 www.corehighways.com	
Produced by: Ash Williams	
Design reference: ADW/21.01.25/J131354	



Sign Schedule



ID: 001 Qty: 2 Ref: 13.9
 Schedule 13-9 : Temporary Information
 Size: 970 x 1069 @ 75 X-Hgt

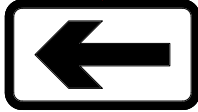

ID: 002 Qty: 1 Ref: 573
 Direction to hazard left
 Size: 600 x 400 @ 100 X-Hgt



ID: 003 Qty: 2 Ref: 2702
 Diversion Ends
 Size: 1050 x 1000

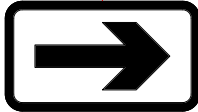

ID: 004 Qty: 5 Ref: 573
 Direction to hazard right
 Size: 600 x 400 @ 100 X-Hgt



ID: 005 Qty: 8 Ref: 7001
 Road works ahead
 Size: 750 High



ID: 006 Qty: 8 Ref: 7010.1
 Nature of temporary hazard ahead - Road Ahead Closed
 Size: 1176 x 938 @ 75 X-hgt



ID: 007 Qty: 4 Ref: 2702
 Diversion
 Size: 1050 x 1000



ID: 008 Qty: 1 Ref: 2702
 Diversion
 Size: 1050 x 1000



ID: 009 Qty: 2 Ref: 7010.1
 Nature of temporary hazard ahead - Road Closed
 Size: 782 x 788 @ 75 X-hgt



Information Boards to be taken to site and placed at either end of works

TRAFFIC MANAGEMENT NOTES:
 1) All temporary traffic management shall be in accordance with Chapter 8 of the Traffic Signs Manual.
 2) All temporary traffic management shall be in accordance with the Traffic Signs Regulations and General Directions 2016.
 3) All temporary traffic management shall conform to the Safety of Street Works and Road Works, A Code of Practice.
 4) All signing should be located 450mm minimum from any carriageway.
 5) All temporary traffic management sign locations are indicative and are subject to on site approval from the Engineer.

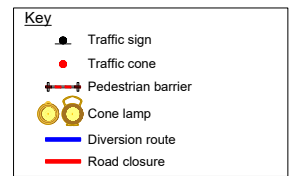

Checked by: Adrian Crees

Customer: MWS LTD

Job reference: 96730761

Location: Ty Glyn, Dyffryn Arth, Ceredigion SA48 8DL



Date: 21/01/2025

Description: Road Closure

Scale: NTS OS HA: 0

0330 043 3030
 www.corehighways.com

Produced by: Ash Williams

Design reference: ADW/21.01.25/J131354

This Design is subject to Copyright and remains the property of Core Highways.
 Contains Ordnance Survey data.

