

Access and Egress for local residents to be maintained by MGW

TRAFFIC MANAGEMENT NOTES:
 1) All temporary traffic management shall be in accordance with Chapter 8 of the Traffic Signs Manual.
 2) All temporary traffic management shall be in accordance with the Traffic Signs Regulations and General Directions 2016.
 3) All temporary traffic management shall conform to the Safety at Street Works and Road Works, A Code of Practice.
 4) All signing should be located 450mm minimum from any carriageway.
 5) All temporary traffic management sign locations are indicative and are subject to on site approval from the Engineer.

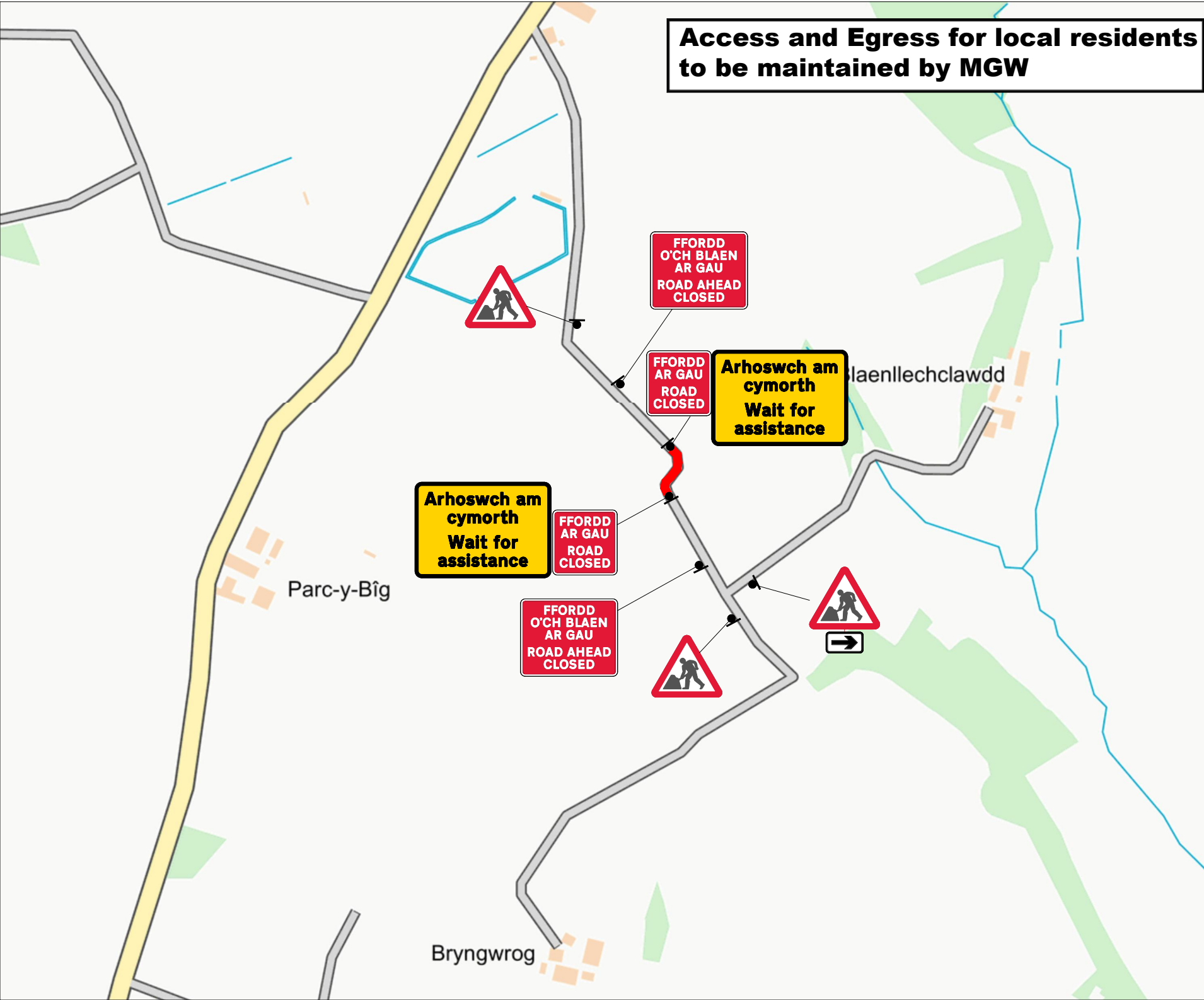

Key	
	Traffic sign
	Traffic cone
	Pedestrian barrier
	Cone lamp
	Diversion route
	Road closure

Checked by: D. Wall

Customer: MGW LTD

Job reference: 96857918

Location: Blaenllechclawdd
 Beulah
 Newcastle Emlyn
 SA38 9QR



Date: 01/05/2025

Description: Road Closure

Scale: NTS OS HA: 0

0330 043 3030
 www.corehighways.com

Produced by: Chris Collier-Evans

Design reference: CE/01.05.25/J136158

This Design is subject to Copyright and remains the property of Core Highways.
 Contains Ordnance Survey data.



Sign Schedule



ID: 001 Item: Qty: 2 Ref: 13.9
Schedule 13-9 : Temporary Information
Size: 1494 x 1050 @ 100 X-Hgt

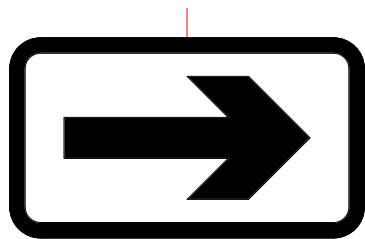

ID: 002 Item: Qty: 1 Ref: 573
Direction to hazard right
Size: 600 x 400 @ 100 X-Hgt



ID: 003 Item: Qty: 3 Ref: 7001
Road works ahead
Size: 750 High



ID: 004 Item: Qty: 2 Ref: 7010.1
Nature of temporary hazard ahead - Road Ahead Closed
Size: 1176 x 938 @ 75 X-hgt



ID: 005 Item: Qty: 2 Ref: 7010.1
Nature of temporary hazard ahead - Road Closed
Size: 782 x 788 @ 75 X-hgt

TRAFFIC MANAGEMENT NOTES:
1) All temporary traffic management shall be in accordance with Chapter 8 of the Traffic Signs Manual.
2) All temporary traffic management shall be in accordance with the Traffic Signs Regulations and General Directions 2016.
3) All temporary traffic management shall conform to the Safety at Street Works and Road Works, A Code of Practice.
4) All signing should be located 450mm minimum from any carriageway.
5) All temporary traffic management sign locations are indicative and are subject to on site approval from the Engineer.

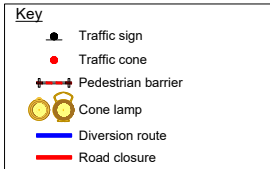

Checked by: D. Wall

Customer: MGW LTD

Job reference: 96857918

Location: Bleanlechclawdd
Beulah
Newcastle Emlyn
SA38 9QR



Date: 01/05/2025

Description: Road Closure

Scale: NTS OS HA: 0

0330 043 3030
www.corehighways.com

Produced by: Chris Collier-Evans

Design reference: CE/01.05.25/J136158

This Design is subject to Copyright and remains the property of Core Highways.
Contains Ordnance Survey data.

core
highways